



**WARNING**

Read and understand all instructions prior to installing or using this product. The following are general safety warnings intended to bring attention to proper installation and areas of the product where proper usage must be followed. Failure to follow instructions could lead to product damage, product failure and/or serious injury, or death.

DO NOT machine wash or dry clean the product. Exposure to detergents, bleach, or solvents may result in expedited degradation and compromise the product.

Inspect the product for discoloration, cuts, tears, abrasions or cracks before and after each use.

DO NOT expose the product to open flame or excessive heat.

DO NOT alter the product in any way.

**OPERATOR'S MANUAL**

# **MULTI-PLATFORM RADIO CHASSIS (MPRC) Mk5 v1.01**

The Multi-Platform Radio Chassis (MPRC) Mk5 is a modular and scalable approach to radio retention that can accommodate a wide range of radio models. The chassis is a three-part system that allows the internal dimensions of the MPRC to expand and contract as needed. With this wide fitment range, almost any radio model can be properly secured and ventilated while maintaining the full range of functions on the handset.

## **CONTENTS**

- 02 ..... ASSEMBLING THE BATTERY CUP & STRAP
- 03 ..... MOLLE & BELT PASSTHROUGH MOUNTING

DESIGNED, TESTED, AND MANUFACTURED IN **THE USA**

CAGE CODE **81JG6** DUNS **08-185-0461**

112 BUD PLACE, ABERDEEN, NC 28315  
GENERAL INQUIRIES: [INFO@SPIRITUSSYSTEMS.COM](mailto:INFO@SPIRITUSSYSTEMS.COM)

# SEC 01 ASSEMBLING THE BATTERY CUP & STRAP

The MPRC Mk5 features two adjustable components that allow you to change the overall height, width, and depth of the chassis. Follow these steps to properly fit the chassis to your radio.

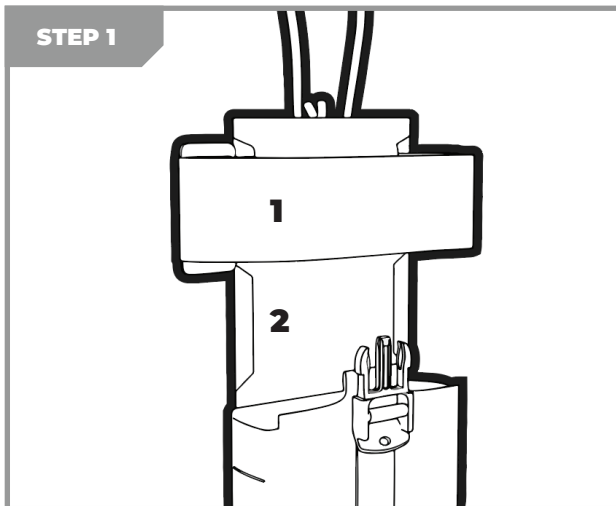

Insert the top strap into one of the two provided slots on the front of the chassis backer.

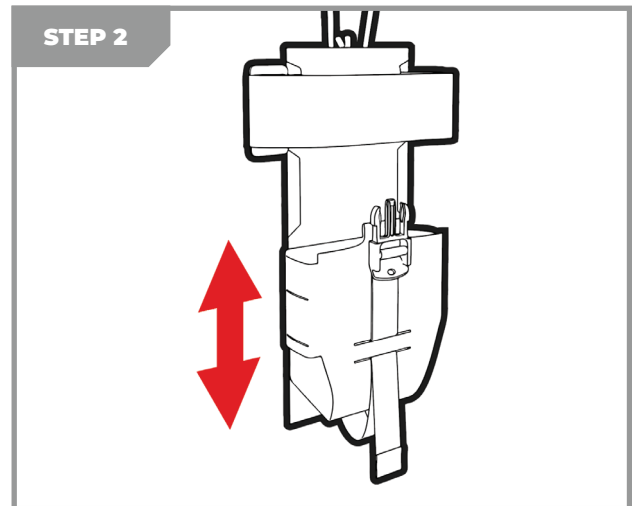

The battery cup can be adjusted for height by selecting the appropriate MOLLE loops on the front of the backer when mounting the cup. Test fit the radio then begin threading the

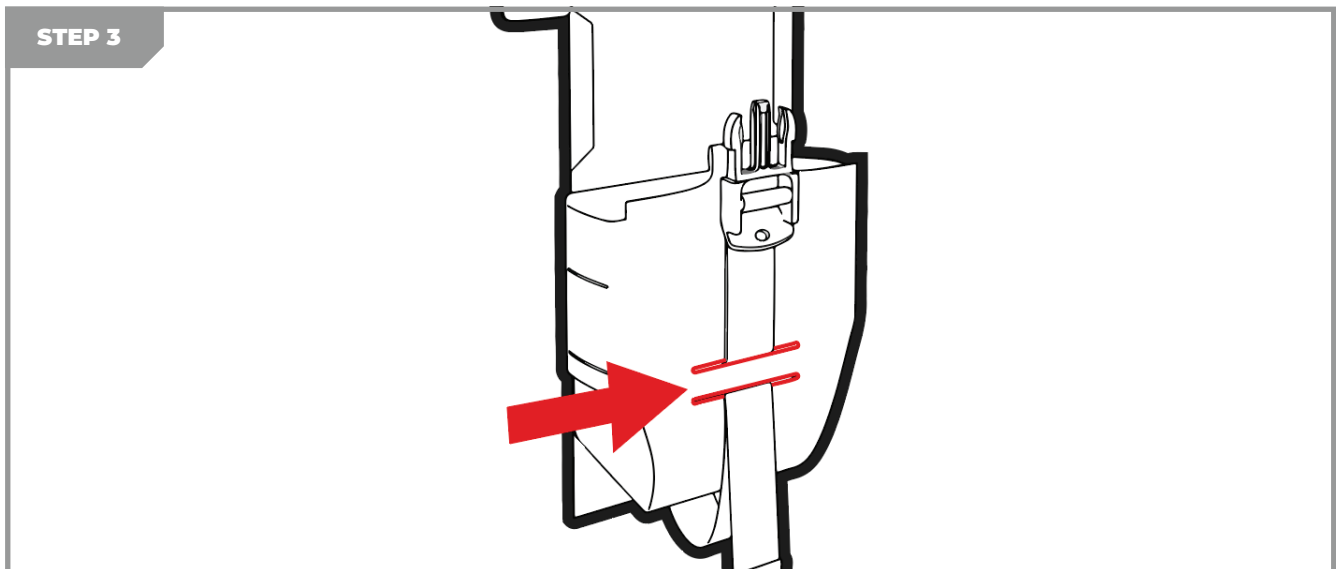

Once your battery cup is properly sized, thread the fastex buckle loop through the battery cup to provide an additional layer of retention to the radio chassis. You can adjust the top buckle loop by moving the location of the overhand knot on the back of the chassis.



## SEC 02 MOLLE & BELT PASSTHROUGH MOUNTING

The MPRC Mk5 can be mounted to body armor, chest rigs, and packs using its two MOLLE columns, or on the waist via the integrated belt pass-through. It can accommodate belts up to 2" wide.

### STEP 1

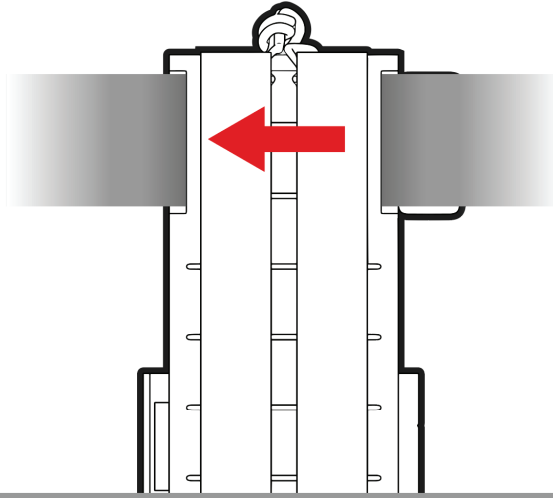

The belt passthrough can be found at the top of the back side of the chassis. Make sure to thread the MOLLE straps through the chassis backer to keep the secure and the chassis snag-free.

### STEP 2

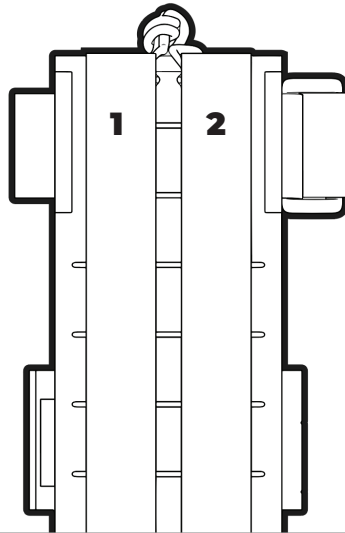

The MPRC Mk5 uses two columns of MOLLE and can be mounted to cummerbunds, MOLLE Belts, packs, and chest rigs. When mounting the MPRC Mk5, make sure the top fastex buckle loop has been preadjusted. Once mounted via MOLLE, it will be difficult to adjust this component of the chassis.

